

Series CTF Powder Ore Dry Drum PM Separator

Specification

English Version
For reference only

General Introduction The CTF series powder ore dry drum permanent magnetic separator is for pre-separation of particle size among 0 ~1mm, between 5% and 20% of low grade magnetite and dry powder ore.



- Features**
- The multi-pole is arranged in the internal magnetic system and can increase the stirring of the magnetic particles.
 - 180°broad-angle magnetic system can effectively improve recovery rate of iron ore.
 - Drum surface used in wear-resistant ceramics, the hardness of HRA ≥85
 - Simple material distribution structure, and more convenient to control the fine, tailing grade.

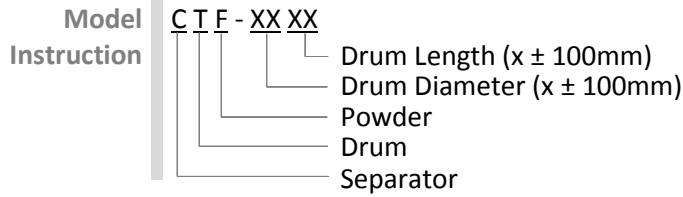

Specification Table

Model	Drum Size (D x L)	Drum Surface Magnetic Induction Intensity	Process Capacity	Drum Revolving Speed	Motor Power	Dimension	Unit Weight
	mm	mT	ton/h	r/min	kW	mm	kg
CTF-0818	800 × 1800	The Magnetic induction intensity is based on the type of mineral. Able to design according to custom specification	55-70	0-50	11	3455×1150×1940	3300
CTF-0821	800 × 2100		70-85	0-50	15	3755×1150×1940	3900
CTF-0824	800 × 2400		85-100	0-50	18.5	4155×1150×1940	4450
CTF-1021	1000 × 2100		100-130	0-50	18.5	3915×1340×2035	4800
CTF-1024	1000 × 2400		120-150	0-50	18.5	4215×1340×2035	5370
CTF-1030	1000 × 3000		160-200	0-50	30	4815×1340×2035	6250

Outline Dimension & Installation

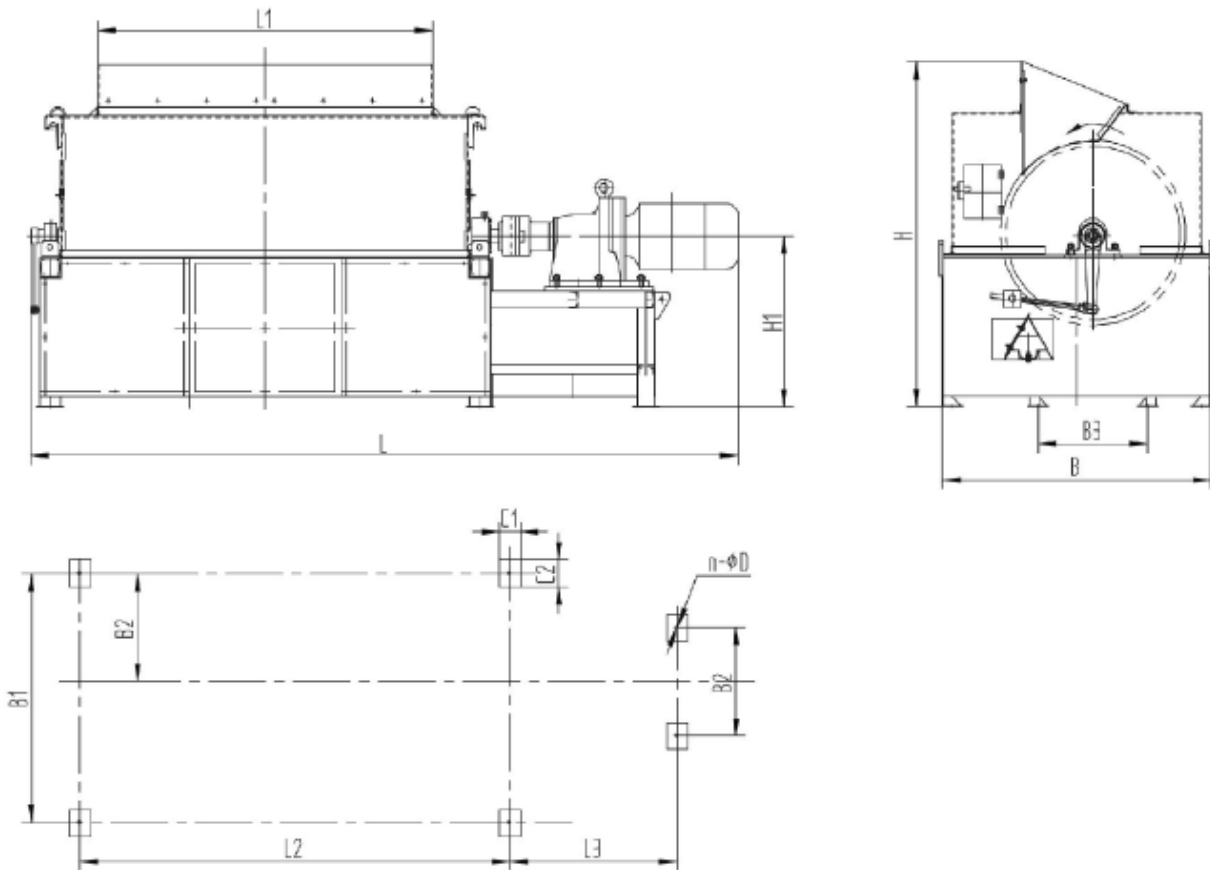

Model	L	L1	L2	L3	B	B1	B2	B3	C1	C2	H	H1	n	D
	mm	mm	mm	mm	mm	mm	mm	mm	mm	mm	mm	mm	mm	mm
CTF0821	3755	1900	2381	850	1425	1312	590	590	120	150	1650	822	6	22
CTF1021	4017	1900	2437	950	1525	1413	615	620	120	150	1960	972	6	22
CTF1024	4317	2200	2737	950	1525	1413	615	620	120	150	1960	972	6	22
CTF1030	5100	2800	3337	1000	1525	1413	615	620	120	150	1960	972	6	22